

※O plantão médico de emergência das clínicas e hospitais está sujeito a alterações. Favor telefonar antes para tel 336-1111 (Shimizu-ku) ou então para tel 0800-222-1199 (Aoi e Suruga-ku) e checar os locais e horários.

※Pessoas que não dominam o idioma japonês, favor ir acompanhados com alguém que pode servir como intérprete.

※O plantão médico de emergência das clínicas e hospitais está sujeito a alterações. Favor telefonar antes para tel 336-1111 (Shimizu-ku) ou então para tel 0800-222-1199 (Aoi e Suruga-ku) e checar os locais e horários.

※Pessoas que não dominam o idioma japonês, favor ir acompanhados com alguém que pode servir como intérprete.

※Departamento de pediatria: somente para menores de 15 anos.

※Não se esqueça de levar sua caderneta/cartão de Seguro de Saúde e dinheiro.

| Plantão médico de emergência noturno<br>(Clínica geral・Pediatría・Clínica cirúrgica geral) |       |   |                               |                   |          |                   |
|---|-------|---|-------------------------------|-------------------|----------|-------------------|
| DIA   | Dept. | 19:00-22:00<br>Shizuoka-shi, Kyubyo<br>Center | 22:00-8:30<br>Aoi e Suruga-ku |                   | Hospital |                   |
|   |       |   | D                             | D                 |          |                   |
| 1   |       |   | 内                             | SHIZUOKA KOSEI    | 内        | SAKURAGAOKA       |
|   |       |   | 小                             | KODOMO            | 小        | KODOMO            |
|   |       |   | 外                             | KENRITSU SOGO     | 外        | SHIRITSU SHIMIZU  |
| 2   |       |   | 内                             | KENRITSU SOGO     | 内        | SAKURAGAOKA       |
|   |       |   | 小                             | SAISEIKAI         | 小        | SAISEIKAI         |
|   |       |   | 外                             | SHIRITSU SHIZUOKA | 外        | SHIMIZU KOSEI     |
| 3   |       |   | 内                             | SHIRITSU SHIZUOKA | 内        | TOKUSHUKAI        |
|   |       |   | 小                             | KENRITSU SOGO     | 小        | KENRITSU SOGO     |
|   |       |   | 外                             | SEKIJUJI          | 外        | SHIRITSU SHIMIZU  |
| 4   |       |   | 内                             | SEKIJUJI          | 内        | SAKURAGAOKA       |
|   |       |   | 小                             | SHIRITSU SHIZUOKA | 小        | SHIRITSU SHIZUOKA |
|   |       |   | 外                             | SAISEIKAI         | 外        | SHIRITSU SHIMIZU  |
| 5   |       |   | 内                             | KENRITSU SOGO     | 内        | SHIRITSU SHIMIZU  |
|   |       |   | 小                             | SAISEIKAI         | 小        | SAISEIKAI         |
|   |       |   | 外                             | SHIRITSU SHIZUOKA | 外        | SHIMIZU KOSEI     |
| 6   |       |   | 内                             | SHIZUOKA KOSEI    | 内        | SAKURAGAOKA       |
|   |       |   | 小                             | KODOMO            | 小        | KODOMO            |
|   |       |   | 外                             | SAISEIKAI         | 外        | SHIRITSU SHIMIZU  |
| 7   |       |   | 内                             | SAISEIKAI         | 内        | SAKURAGAOKA       |
|   |       |   | 小                             | SHIRITSU SHIMIZU  | 小        | SHIRITSU SHIMIZU  |
|   |       |   | 外                             | SHIRITSU SHIZUOKA | 外        | SHIMIZU KOSEI     |
| 8   |       |   | 内                             | SHIRITSU SHIZUOKA | 内        | SAKURAGAOKA       |
|   |       |   | 小                             | KODOMO            | 小        | KODOMO            |
|   |       |   | 外                             | SEKIJUJI          | 外        | SHIRITSU SHIMIZU  |
| 9   |       |   | 内                             | KENRITSU SOGO     | 内        | SAKURAGAOKA       |
|   |       |   | 小                             | KODOMO            | 小        | KODOMO            |
|   |       |   | 外                             | SHIZUOKA KOSEI    | 外        | SHIMIZU KOSEI     |
| 10  |       |   | 内                             | SEKIJUJI          | 内        | SAKURAGAOKA       |
|   |       |   | 小                             | KENRITSU SOGO     | 小        | KENRITSU SOGO     |
|   |       |   | 外                             | SAISEIKAI         | 外        | SHIRITSU SHIMIZU  |
| 11  |       |   | 内                             | SHIRITSU SHIZUOKA | 内        | SHIRITSU SHIMIZU  |
|   |       |   | 小                             | SAISEIKAI         | 小        | SAISEIKAI         |
|   |       |   | 外                             | SEKIJUJI          | 外        | SHIMIZU KOSEI     |
| 12  |       |   | 内                             | SAISEIKAI         | 内        | SAKURAGAOKA       |
|   |       |   | 小                             | KODOMO            | 小        | KODOMO            |
|   |       |   | 外                             | KENRITSU SOGO     | 外        | SHIMIZU KOSEI     |
| 13  |       |   | 内                             | SHIRITSU SHIZUOKA | 内        | SHIMIZU KOSEI     |
|   |       |   | 小                             | SAISEIKAI         | 小        | SAISEIKAI         |
|   |       |   | 外                             | SEKIJUJI          | 外        | SHIRITSU SHIMIZU  |
| 14  |       |   | 内                             | SHIZUOKA KOSEI    | 内        | SAKURAGAOKA       |
|   |       |   | 小                             | KENRITSU SOGO     | 小        | KENRITSU SOGO     |
|   |       |   | 外                             | SAISEIKAI         | 外        | SAISEIKAI         |
| 15  |       |   | 内                             | SAISEIKAI         | 内        | SAKURAGAOKA       |
|   |       |   | 小                             | SEKIJUJI          | 小        | SEKIJUJI          |
|   |       |   | 外                             | KENRITSU SOGO     | 外        | SHIRITSU SHIMIZU  |

※Shizuoka-shi Kyubyo Center  
Aoi-ku, Yunoki 240, Tel: 054-261-1111

【Hospital】

- KENRITSU SOGO : KENRITSU SOGO BYOIN  
AOI-KU, KITA ANDO 4chome 27-1 TEL 247-6111
- KODOMO : KENRITSU KODOMO BYOIN  
AOI-KU, URUSHIYAMA 860 TEL 247-6251
- SAISEIKAI : SHIZUOKA SAISEIKAI BYOIN  
SURUGA-KU, OSHIKA 1chome 1-1 TEL 285-6171
- SEKIJUJI : SHIZUOKA SEKIJUJI BYOIN  
AOI-KU, OTE-MACHI 8-2 TEL 254-4311
- TOKUSHUKAI : SHIZUOKA TOKUSHUKAI BYOIN  
SURUGA-KU, SHIMOKAWAHARA MINAMI TEL 256-8008

| Plantão médico de emergência noturno<br>(Clínica geral・Pediatría・Clínica cirúrgica geral) |       |   |                               |                   |          |                   |
|---|-------|---|-------------------------------|-------------------|----------|-------------------|
| DIA   | Dept. | 19:00-22:00<br>Shizuoka-shi, Kyubyo<br>Center | 22:00-8:30<br>Aoi e Suruga-ku |                   | Hospital |                   |
|   |       |   | D                             | D                 |          |                   |
| 16  |       |   | 内                             | SEKIJUJI          | 内        | SAKURAGAOKA       |
|   |       |   | 小                             | KODOMO            | 小        | KODOMO            |
|   |       |   | 外                             | SHIRITSU SHIZUOKA | 外        | SHIMIZU KOSEI     |
| 17  |       |   | 内                             | KENRITSU SOGO     | 内        | SHIRITSU SHIMIZU  |
|   |       |   | 小                             | SHIRITSU SHIZUOKA | 小        | SHIRITSU SHIZUOKA |
|   |       |   | 外                             | SEKIJUJI          | 外        | SEKIJUJI          |
| 18  |       |   | 内                             | SHIRITSU SHIZUOKA | 内        | TOKUSHUKAI        |
|   |       |   | 小                             | SHIRITSU SHIMIZU  | 小        | SHIRITSU SHIMIZU  |
|   |       |   | 外                             | KENRITSU SOGO     | 外        | SHIRITSU SHIMIZU  |
| 19  |       |   | 内                             | SEKIJUJI          | 内        | SHIRITSU SHIZUOKA |
|   |       |   | 小                             | KODOMO            | 小        | KODOMO            |
|   |       |   | 外                             | SAISEIKAI         | 外        | SHIMIZU KOSEI     |
| 20  |       |   | 内                             | SHIRITSU SHIZUOKA | 内        | SHIRITSU SHIMIZU  |
|   |       |   | 小                             | SAISEIKAI         | 小        | SAISEIKAI         |
|   |       |   | 外                             | KENRITSU SOGO     | 外        | KENRITSU SOGO     |
| 21  |       |   | 内                             | SAISEIKAI         | 内        | SAISEIKAI         |
|   |       |   | 小                             | KODOMO            | 小        | KODOMO            |
|   |       |   | 外                             | SHIRITSU SHIZUOKA | 外        | SHIMIZU KOSEI     |
| 22  |       |   | 内                             | KENRITSU SOGO     | 内        | SAKURAGAOKA       |
|   |       |   | 小                             | SAISEIKAI         | 小        | SAISEIKAI         |
|   |       |   | 外                             | SEKIJUJI          | 外        | SHIRITSU SHIMIZU  |
| 23  |       |   | 内                             | SHIRITSU SHIZUOKA | 内        | SAKURAGAOKA       |
|   |       |   | 小                             | SHIRITSU SHIMIZU  | 小        | SHIRITSU SHIMIZU  |
|   |       |   | 外                             | SHIZUOKA KOSEI    | 外        | SHIMIZU KOSEI     |
| 24  |       |   | 内                             | SAISEIKAI         | 内        | SAKURAGAOKA       |
|   |       |   | 小                             | KENRITSU SOGO     | 小        | KENRITSU SOGO     |
|   |       |   | 外                             | SHIRITSU SHIZUOKA | 外        | SHIRITSU SHIMIZU  |
| 25  |       |   | 内                             | KENRITSU SOGO     | 内        | SHIRITSU SHIMIZU  |
|   |       |   | 小                             | SHIRITSU SHIZUOKA | 小        | SHIRITSU SHIZUOKA |
|   |       |   | 外                             | SEKIJUJI          | 外        | SHIMIZU KOSEI     |
| 26  |       |   | 内                             | SEKIJUJI          | 内        | SAKURAGAOKA       |
|   |       |   | 小                             | SAISEIKAI         | 小        | SAISEIKAI         |
|   |       |   | 外                             | KENRITSU SOGO     | 外        | SHIMIZU KOSEI     |
| 27  |       |   | 内                             | SAISEIKAI         | 内        | SAKURAGAOKA       |
|   |       |   | 小                             | SHIZUOKA KOSEI    | 小        | SHIZUOKA KOSEI    |
|   |       |   | 外                             | SHIRITSU SHIZUOKA | 外        | SHIRITSU SHIMIZU  |
| 28  |       |   | 内                             | SEKIJUJI          | 内        | SAKURAGAOKA       |
|   |       |   | 小                             | SHIRITSU SHIMIZU  | 小        | SHIRITSU SHIMIZU  |
|   |       |   | 外                             | SAISEIKAI         | 外        | SHIMIZU KOSEI     |
| 29  |       |   | 内                             | SHIZUOKA KOSEI    | 内        | SAKURAGAOKA       |
|   |       |   | 小                             | KODOMO            | 小        | KODOMO            |
|   |       |   | 外                             | KENRITSU SOGO     | 外        | SHIRITSU SHIMIZU  |
| 30  |       |   | 内                             | SEKIJUJI          | 内        | SHIRITSU SHIMIZU  |
|   |       |   | 小                             | SAISEIKAI         | 小        | SAISEIKAI         |
|   |       |   | 外                             | SHIRITSU SHIZUOKA | 外        | SHIRITSU SHIZUOKA |
| 31  |       |   | 内                             | KENRITSU SOGO     | 内        | SHIRITSU SHIZUOKA |
|   |       |   | 小                             | KODOMO            | 小        | KODOMO            |
|   |       |   | 外                             | SAISEIKAI         | 外        | SHIRITSU SHIMIZU  |

- SHIRITSU SHIMIZU : SHIRITSU SHIMIZU BYOIN  
SHIMIZU-KU, MIYAKAMI 1231 TEL 336-1111
- SHIRITSU SHIZUOKA : SHIRITSU SHIZUOKA BYOIN  
AOI-KU, OTE-MACHI 10-93 TEL 253-3125
- SHIMIZU KOSEI : SHIMIZU KOSEI BYOIN  
SHIMIZU-KU, IHARA-CHO 578-1 TEL 366-3333
- SHIZUOKA KOSEI : SHIZUOKA KOSEI BYOIN  
AOI-KU, KITABAN-CHO 23 TEL 271-7177

**Plantão médico de emergência aos sábados  
Aoi e Suruga-ku**

| DIA | Dept. | Internal Medicine • Pediatrics • Surgery (13:00-19:00) |                                      |          |
|-----|-------|--|--------------------------------------|----------|
|     |       | Clínica  | Endereço<br>(A):AOI-KU (S):SURUGA-KU | Tel      |
| 4   | 内     | TERAMURA CLINIC (NAIKA)                                | (A) CHIYODA 6chome                   | 267-3888 |
|     | 小     | TERAMURA CLINIC (SHONIKA)                              | (A) CHIYODA 6chome                   | 263-1771 |
|     | 外     | SHIBA SEIKEIGKA  | (A) SAKAE-CHO                        | 254-1576 |
| 11  | 内     | TOYAMA CLINIC  | (S) TOSHINDEN 2chome                 | 201-9800 |
|     | 小     | NISHIZAWA CLINIC                                       | (S) KAMATA                           | 259-8777 |
|     | 外     | MOCHIZUKI SEIKEIGKA                                    | (A) KUTSUNOYA 4chome                 | 248-1151 |
| 18  | 内     | AOYAMA NAIKA SHONIKA                                   | (A) KITA 1chome                      | 245-9832 |
|     | 小     | SENA CLINIC  | (A) SENACHUO 3chome                  | 261-9790 |
|     | 外     | YAMANASHI SEIKEIGKA                                    | (A) KOMAGATA-DORI 2chome             | 252-3372 |
| 25  | 内     | KABURAGI NAIKA   | (A) TAKEMI                           | 248-0337 |
|     | 小     | MATSUMOTO KODOMO CLINIC                                | (S) KAMIKAWAHARA                     | 259-7755 |
|     | 外     | MATSUTOMI CLINIC                                       | (A) KAMITENMA                        | 205-4777 |

**【Especialidades médicas de clínicas e hospitais】**

- 内: Clínica Geral
- 小: Pediatria
- 外: Clínica Cirúrgica Geral
- 産婦: Ginecologia e obstetrícia
- 耳鼻: Otorrinolaringologia
- 眼: Oftalmologia
- 皮膚: Dermatologia
- 泌尿: Urologia

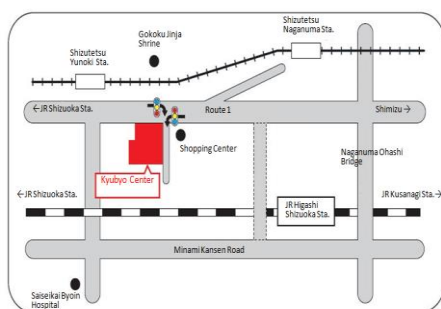

**Plantão médico de emergência nos feriados  
Aoi e Suruga-ku**

| DIA | Dept. | 8:30-19:00                 |                                      |                     |          |
|-----|-------|----------------------------|--------------------------------------|---------------------|----------|
|     |       | Clínica                    | Endereço<br>(A):AOI-KU (S):SURUGA-KU | Tel                 |          |
| 5   | 内     | TANAKA SHOKAKIKA CLINIC    | (A) OTOWA-CHO                        | 247-5522            |          |
|     | 内     | KURIYAMA NAIKA             | (A) SENAGAWA 1chome                  | 262-3471            |          |
|     | 内     | SATO NAIKA                 | (S) MINAMI-CHO                       | 285-2288            |          |
|     | 小     | SURUGA KODOMO CLINIC       | (S)MISE                              | 204-5529            |          |
|     | 産婦    | FUKUMA SANFUJINKA          | (S) NAKAHARA                         | 285-7717            |          |
|     | 耳鼻    | MORIZONO CLINIC            | (S) MISE                             | 202-4133            |          |
|     | 眼     | YANAGIDA GANKA             | (S) MARIKO SERIGAYA-CHO              | 258-7860            |          |
|     | 外     | KONAGAI SEIKEIGKA          | (S) SHINKAWA 2chome                  | 286-0911            |          |
|     | 外     | KAMIASHI SEIKEIGKA         | (A)KAMIASHIARAI 1chome               | 249-5556            |          |
|     | 12    | 内                          | SHIRATORI NAIKA                      | (A) KATAHA-CHO      | 653-0810 |
|     |       | 内                          | SASAKI CLINIC                        | (A) MINAMI SENA-CHO | 262-5811 |
|     |       | 内                          | SHIOKAWA CLINIC                      | (S) YAHATA 5chome   | 280-0500 |
| 小   |       | MORI MORI CLINIC           | (S) SHIMOKAWAHARA 1chome             | 256-8080            |          |
| 耳鼻  |       | OISHI JIBI NODO CLINIC     | Shimizu-ku, TAKAHASHI 5chome         | 367-3341            |          |
| 眼   |       | TOSHINDEN GANKA            | (S) TOSHINDEN 4chome                 | 268-5310            |          |
| 外   |       | YOSHIMURA SEIKEIGKA        | (A) NAGANUMA                         | 261-2828            |          |
| 外   |       | TOSHINDEN FUKUCHI SINRYOIN | (S) TOSHINDEN 5chome                 | 256-8888            |          |
| 19  |       | 内                          | KITAMURA NAIKA                       | (A) ICHIBAN-CHO     | 252-1095 |
|     |       | 内                          | IWAHASHI NAIKA SHONIKA               | (S) MARIKO 2chome   | 259-0347 |
|     | 内     | IYAMA NAIKA                | (S) OGURO 2chome                     | 280-1180            |          |
|     | 小     | NISHINA KODOMO CLINIC      | (A) SENA 3chome                      | 295-5247            |          |
|     | 産婦    | IMAI SANFUJINKA            | (A) SUEHIRO-CHO                      | 275-0341            |          |
|     | 耳鼻    | OTSUBO JIBIKA              | (A) TAMACHI 2chome                   | 205-1139            |          |
|     | 眼     | YAMAMOTO GANKA             | (A) HON-TORI 5chome                  | 252-8833            |          |
|     | 外     | AOSHIMA SEIKEIGKA          | (S) IKEDA                            | 267-3330            |          |
|     | 外     | ASANO GEKA                 | (S) MARIKO 3chome                    | 256-6200            |          |
|     | 21    | 内                          | HONTORI CLINIC                       | (A) HONTORI 1chome  | 275-0234 |
| 内小  |       | KONDO NAIKA SHONIKA        | (S) TEGOSHI                          | 257-0733            |          |
| 内   |       | ENDO NAIKA                 | (S) NAKADA 4chome                    | 284-1121            |          |
| 小   |       | NAKAZAWA KODOMO CLINIC     | (S) KATAYAMA 1chome                  | 289-1110            |          |
| 耳鼻  |       | NONOMURA JIBIKA            | (A) WAKAMATSU-CHO                    | 250-8741            |          |
| 眼   |       | RA GANKA                   | (S) MINAMI-CHO                       | 202-1688            |          |
| 外   |       | FURUKAWA CLINIC            | (A) KITAANDO 4chome                  | 248-3999            |          |
| 外   |       | NOZOMI SEIKEIGKA           | (S) TOYODA 1chome                    | 203-5500            |          |
| 26  | 内     | ENOMOTO NAIKA              | (A) KAWAI 2chome                     | 208-8820            |          |
|     | 内     | MATSUNARI NAIKA            | (A) OIWA-HONCHO                      | 248-5101            |          |
|     | 内     | KONDO CLINIC               | (S) SHIMOJIMA                        | 236-5555            |          |
|     | 小     | MOCHIZUKI SHONIKA          | (A) OTE-MACHI                        | 252-0422            |          |
|     | 耳鼻    | SHIMIZU OKABE CLINIC       | Shimizu-ku, OSHIKIRI                 | 349-3330            |          |
|     | 眼     | HONDA GANKA                | (A) KOUYA-MACHI                      | 251-1125            |          |
|     | 外     | OKAMOTO GEKA               | (S) MAGARIKANE 4chome                | 202-0108            |          |
|     | 外     | SAKAKURA CLINIC            | (S) MINAMI-CHO                       | 202-5800            |          |

**Plantão médico de emergência aos sábados  
Shimizu-ku**

| DIA | Dept. | Internal Medicine • Pediatrics • Surgery (13:00-19:00) |                      |          |
|-----|-------|--|----------------------|----------|
|     |       | Clínica  | Endereço             | Tel      |
| 4   | 内     | FUKUCHI NAIKA GEKA JUNKANKIKI                          | NANATSUSHINYA 2chome | 345-2406 |
|     | 外     | SHIRITSU SHIMIZU BYOIN                                 | MIYAKAMI             | 336-1111 |
| 11  | 内     | MIURA NAIKA JUNKANKIKI IIN                             | ORIDO                | 336-1551 |
|     | 外     | TAKANO SEIKEIGEKA IIN                                  | IHARA-CHO            | 371-1322 |
| 18  | 内     | YAMADA MEDICAL CLINIC                                  | EJIRI-CHO            | 366-0750 |
|     | 外     | SHIRITSU SHIMIZU BYOIN                                 | MIYAKAMI             | 336-1111 |
| 25  | 内     | UTOZAKA SHIINOKI CLINIC                                | UTOZAKA              | 347-6103 |
|     | 外     | SUGIYAMA IIN   | OTE 3chome           | 366-0512 |

**【Especialidades médicas de clínicas e hospitais】**

- 内: Clínica Geral
- 小: Pediatria
- 外: Clínica Cirúrgica Geral
- 産婦: Ginecologia e obstetrícia
- 耳鼻: Otorrinolaringologia
- 眼: Oftalmologia
- 皮膚: Dermatologia
- 泌尿: Urologia

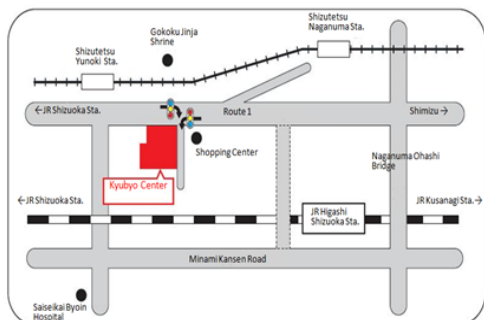

**Plantão médico de emergência aos sábados  
Shimizu-ku**

| DIA | Dept. | Internal Medicine • Pediatrics • Surgery (13:00-19:00) |                      |          |
|-----|-------|--|----------------------|----------|
|     |       | Clínica  | Endereço             | Tel      |
| 5   | 内     | HANAMIZUKITORINAIIKA CLINIC                            | NISHITAKA-CHO        | 355-5500 |
|     | 内     | MIYAJI IIN   | SHIMONO NISHI        | 364-5528 |
|     | 小     | KADOTA KODOMO CLINIC                                   | KITAWAKI             | 344-1180 |
|     | 外     | TOGAWA SEIKEIGEKA                                      | OSAWA-CHO            | 351-8181 |
|     | 皮膚    | HORIGUCHI HIFUKA CLINIC                                | FUJIMI-CHO           | 355-3377 |
| 12  | 内     | WATANABE NAIKA IIN                                     | KAMI SHIMIZU-CHO     | 352-2538 |
|     | 内     | YOSHIDA CLINIC   | GINZA                | 361-0660 |
|     | 内     | AOKI NAIKA CLINIC                                      | OKITSU-NAKACHO       | 369-0044 |
|     | 小     | WATANABE SHONIKA                                       | KINOSHITA-CHO        | 344-2406 |
|     | 外     | MOCHIZUKI CLINIC                                       | OSAWA-CHO            | 352-4375 |
|     | 耳鼻    | OISHI JIBI NODO CLINIC                                 | TAKAHASHI 5chome     | 367-3341 |
| 19  | 内     | ASARI NAIKA CLINIC                                     | MURAMATAUBARA 3chome | 660-8850 |
|     | 内     | ISOGAI IIN   | KUSANAGI 1chome      | 345-7543 |
|     | 小     | SHIMIZU TOMOE CLINIC                                   | CHITOSE-CHO          | 355-1112 |
|     | 外     | MATSUURA SEIKEIGEKA                                    | HIRAKAWAJI           | 344-7500 |
| 21  | 内     | ATSUMI CLINIC  | NAKANOGO 1chome      | 347-5880 |
|     | 内     | INUI IIN   | NISHIKUBO 1chome     | 366-0212 |
|     | 小     | TAKABE KODOMO CLINIC                                   | OSHIKIRI             | 348-5800 |
|     | 外     | MATSUMOTO SEIKEIGEKA                                   | MURAMATSU 1chome     | 337-0228 |
| 26  | 内     | YOSHINAGA IIN  | EJIRI HIGASHI 1chome | 366-2722 |
|     | 内     | ITO (HO) IIN   | HIRAKAWAJI           | 345-7614 |
|     | 小     | HARA SHONIKA IIN                                       | KANDA-CHO            | 352-6367 |
|     | 外     | TSUCHIYA IIN   | MIHO                 | 334-1576 |
|     | 産婦    | OISHI LADIES CLINIC                                    | OSHIKIRI             | 344-1103 |
|     | 耳鼻    | SHIMIZU OKABE CLINIC                                   | OSHIKIRI             | 349-3330 |